

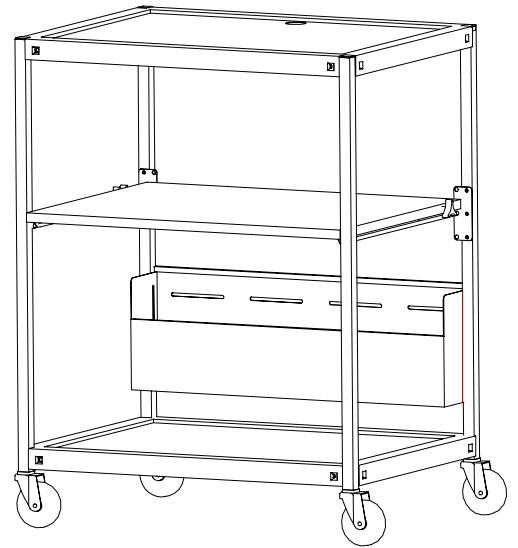

ECILS1 / ECILS1FF

MOBILE COMPUTER WORKSTATION

Assembly Instructions



PARTS LIST

Qty	Part#	Description	Ref
1	022-2006	Top Shelf w/ grommet hole	AA
1	010-3265	Slide Out Shelf	BB
1	010-3953	Bottom Shelf	CC
2	010-2217	Shelf Support Bracket	DD
2	014-0212-900	Shelf Rails	EE
1	022-2311	Right Front Leg	FF
1	022-2310	Left Front Leg	GG
1	022-2313	Right Rear Leg	
1	022-2312	Left Rear Leg	
1	022-2309	Wire Tray	
2	015-0002	4" Casters w/o Lock	
2	015-0003	4" Casters w/ Lock	
2	010-3795	Rail Bracket	
1	CFPS	Electrical Unit - ECILS1FF ONLY	

HARDWARE LIST

Qty	Part#	Description
16	030-0300-21S	5/8" Square Head Bolt
16	030-0002	5/16-18 Hex Serrated Nut
10	030-0304	1/4-20 x 5/8" Combo Screw
2	030-0305	7/8" x 17/64" Washer
2	030-0347	1/4-20 x 3/4" Black Knob
2	020016	#6-32 Hex Nuts - ECILS1FF ONLY
2	020017	#6-32 x 1/4" Screws - ECILS1FF ONLY
1	010-1106	Hex Wrench

TOOLS REQUIRED

- Hex Wrench (Provided)
- Phillips Screwdriver
- Rubber Mallet

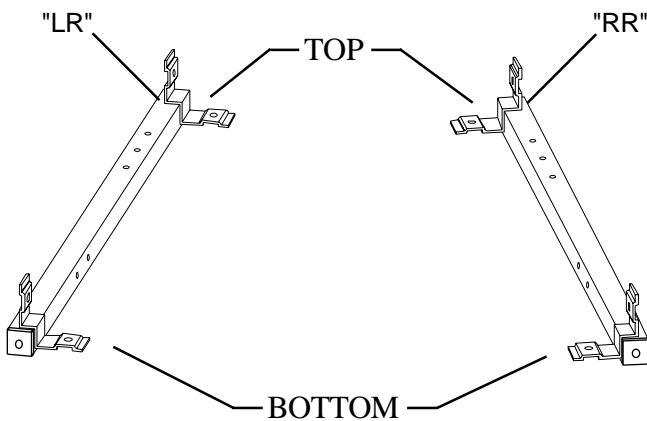
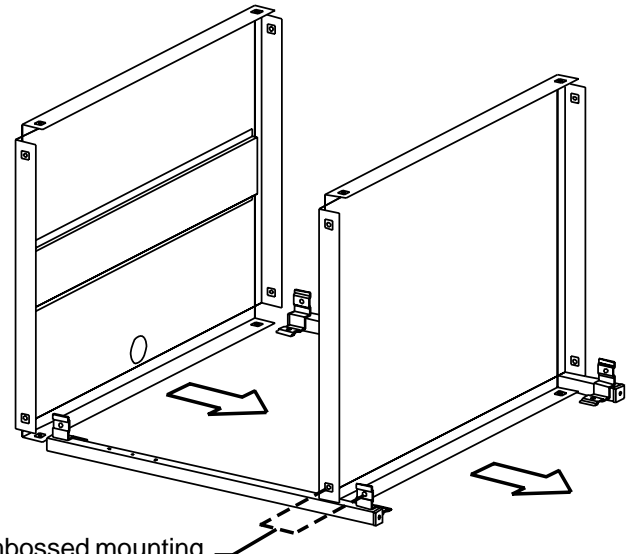

FIGURE 1



Align shelf embossed mounting hole with leg mounting bracket. 2 corners each shelf.

FIGURE 2

STEP 1

Lay the rear legs on a carpeted surface (they are stamped "LR" and "RR") with the three top holes facing up and the bracket facing up as shown in **Figure 1**. Slide the top shelf (with hole at rear) and bottom shelf (with 4 square holes toward front) onto the legs so that the brackets are inside the shelves (**see Figure 2**).

Align shelf embossed mounting hole with leg mounting bracket. 2 corners each shelf.

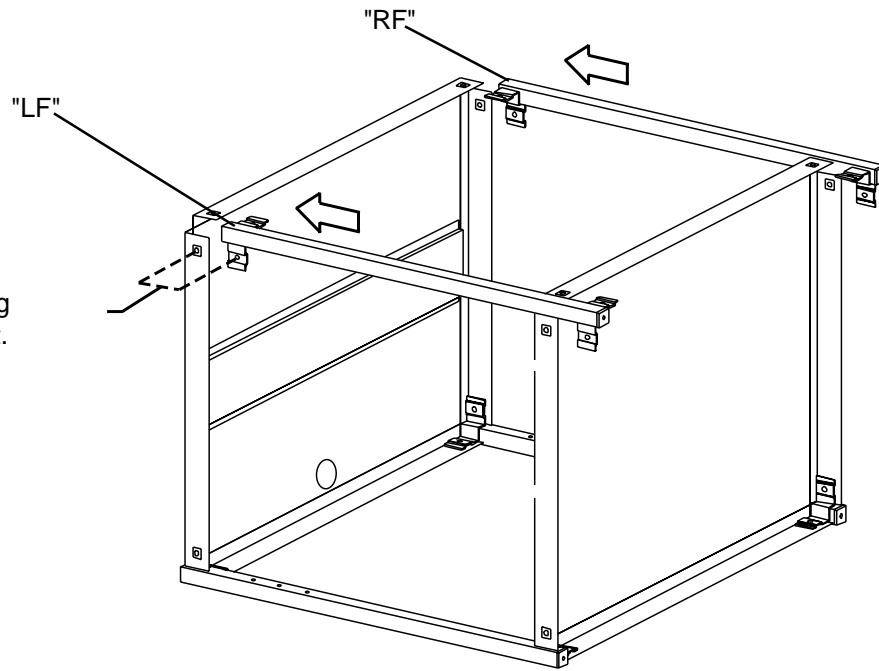

STEP 2

Slide the front legs (they are stamped "LF" and "RF") onto the shelves so that the brackets are inside the shelves.

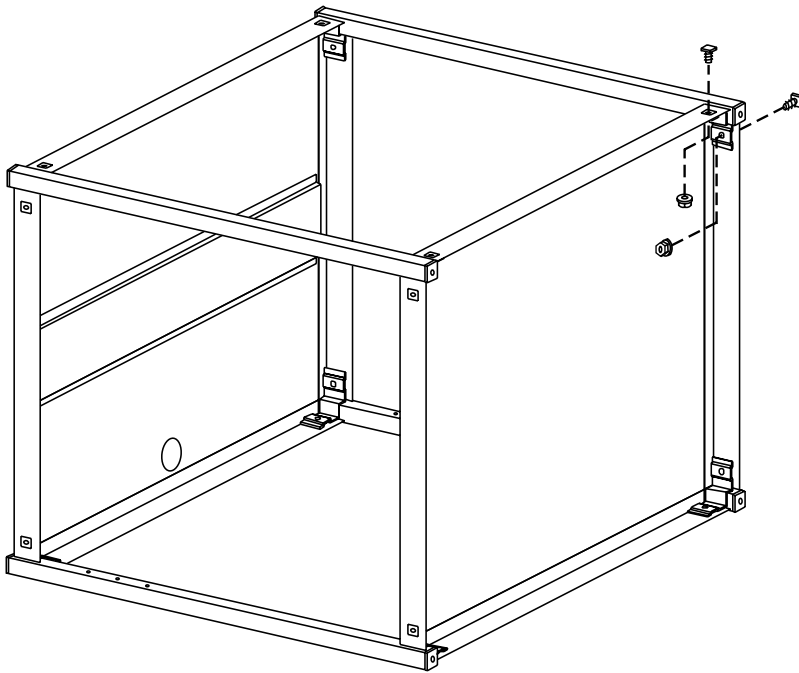

STEP 3

Secure shelves and legs together with bolts (AA) and nuts (BB) in each corner as shown.

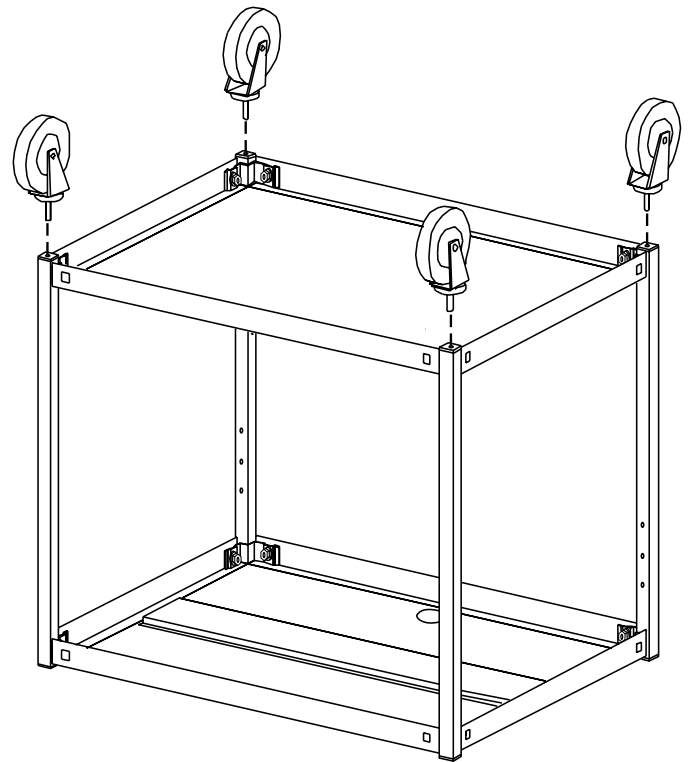
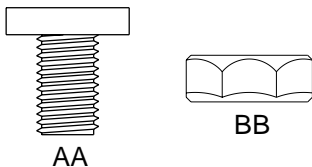

STEP 4

Insert each caster into the bottom of each leg. If caster does not insert easily, use a rubber mallet to tap caster in place. Once casters are **SECURELY** in place, stand unit upright.

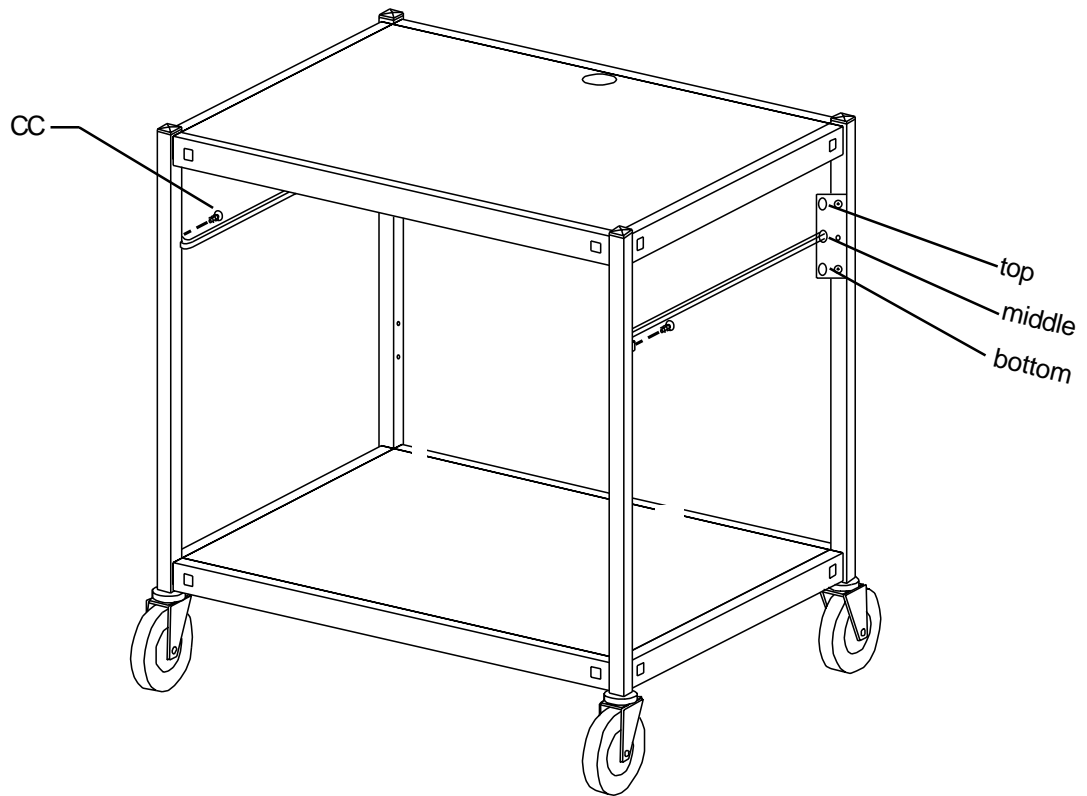
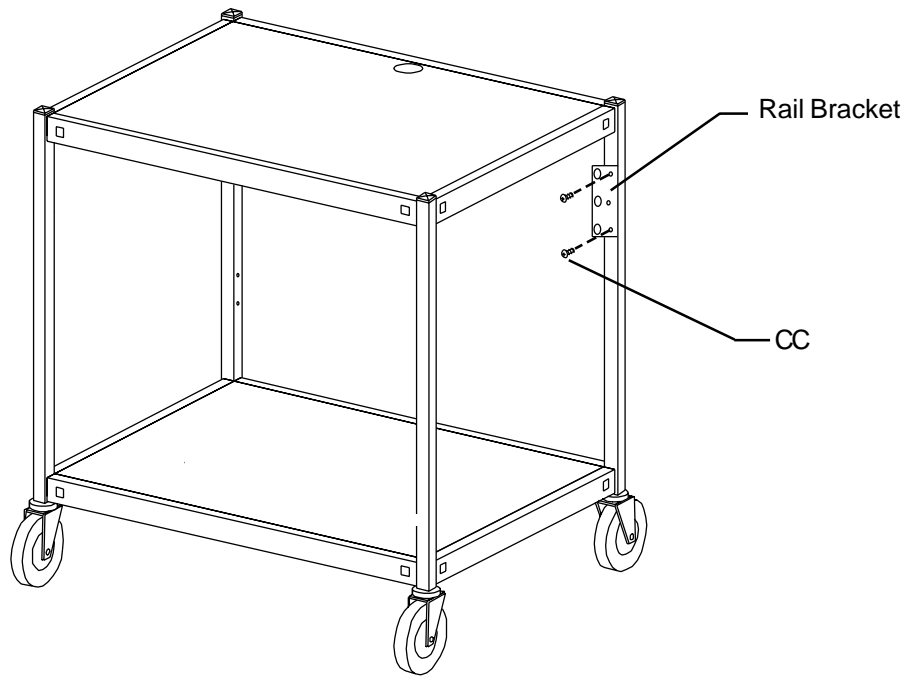

STEP 5

Attach rail brackets to upper portion of rear legs with screws (CC) as shown. Insert straight end of each shelf rail in the rail bracket hole (depending on your requirement; the top, middle, or bottom holes) and attach other swaged end to front leg using screws (CC) as shown

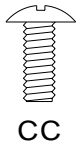
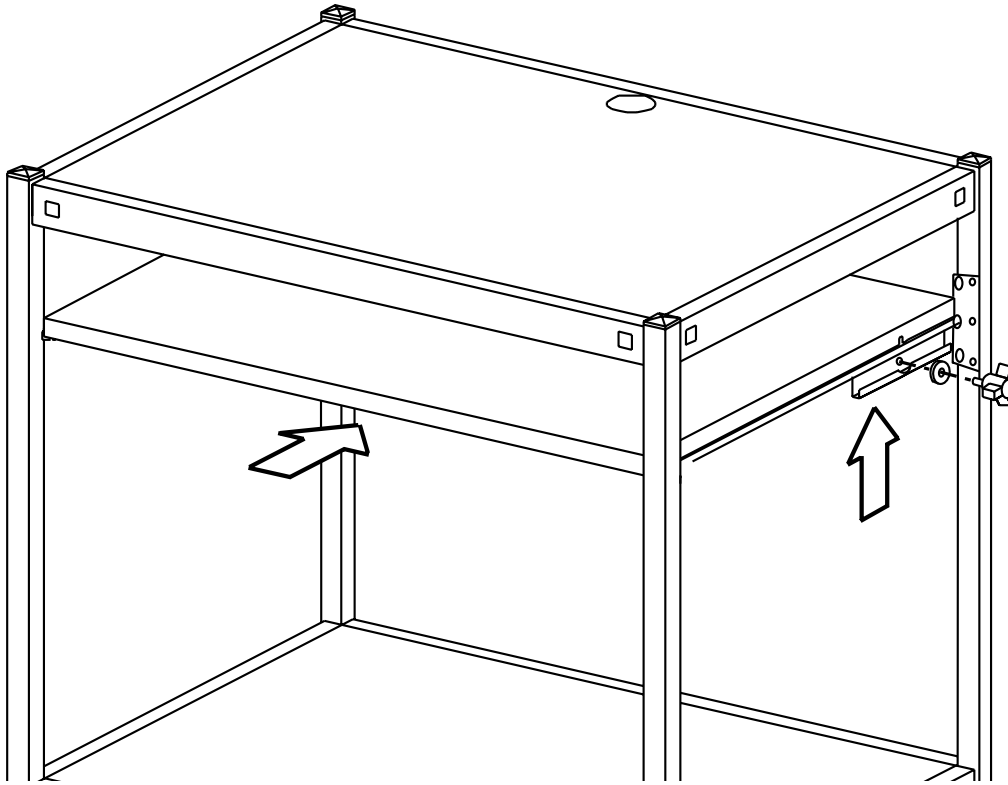

STEP 6

Slide the slide out shelf onto the rails. Position the support bracket so that the flange with the cut out is in front of the rail and the rest of the bracket is behind the shelf. Align bracket with hole in shelf and secure with washer (DD) and knob (EE) as shown.

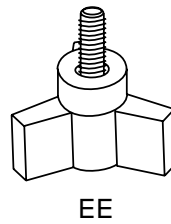
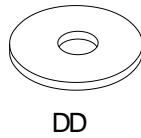

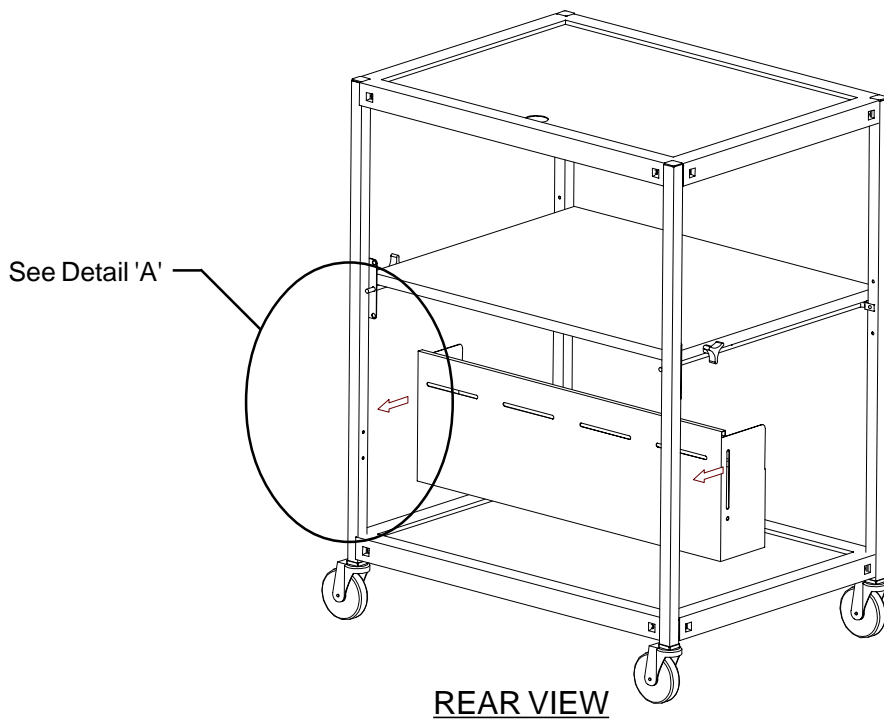

STEP 7

Slide the cord bin between the rear legs and align slotted holes of the cord bin sides with the (2) mounting holes of the legs. Position the cord bin per Detail 'A' to obtain desired height and install four screws (CC).

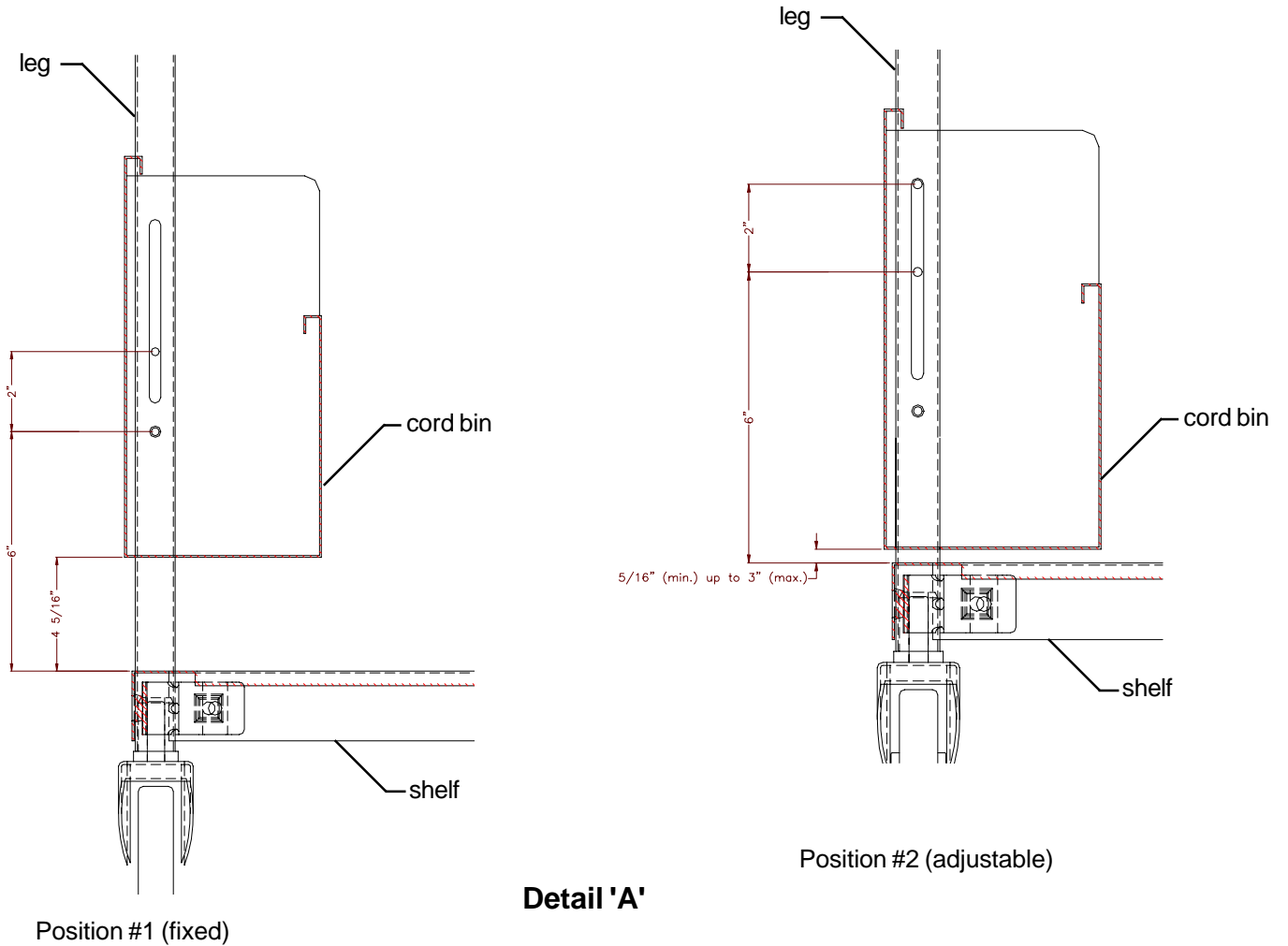

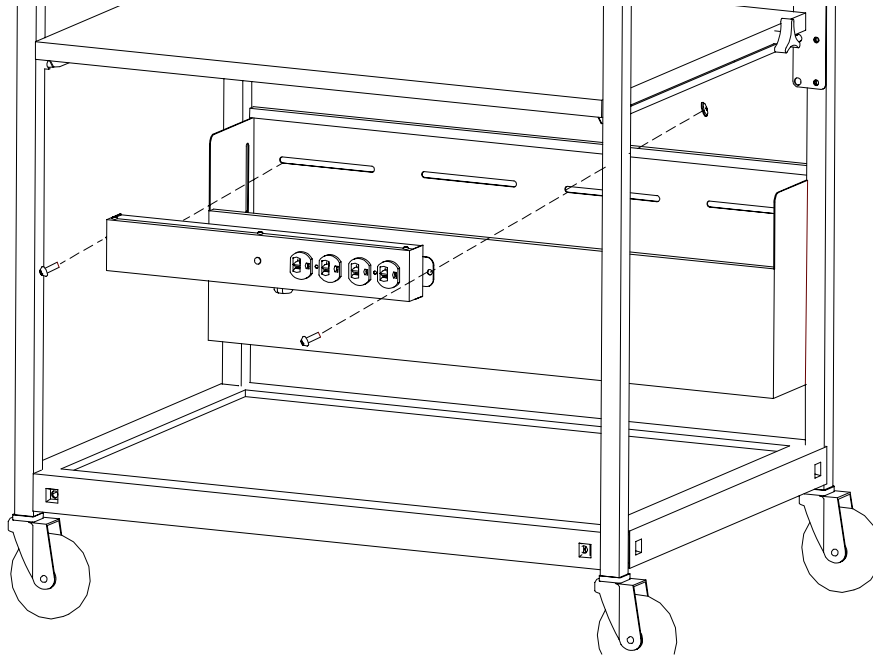

STEP 8 - FOR MODEL ECILS1FF ONLY

Align the CFPS electrical unit with the slots in the inside of the cord bin.
Secure the unit in place with screws (FF) and nuts (GG) as shown.

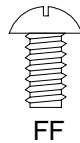

Bretford
11000 Seymour Avenue
Franklin Park, IL 60131
TEL: 847.678.2545
800.521.9614
FAX: 847.678.0852
800.343.1779

Bretford Ltd.
Technology House
7 Lake End Court, Taplow
Bucks SL6 0JQ England
TEL: 01628 603558
FAX: 01628 604923

www.bretford.com

Part # 031-6487
Rev: 11.06.03 CH