

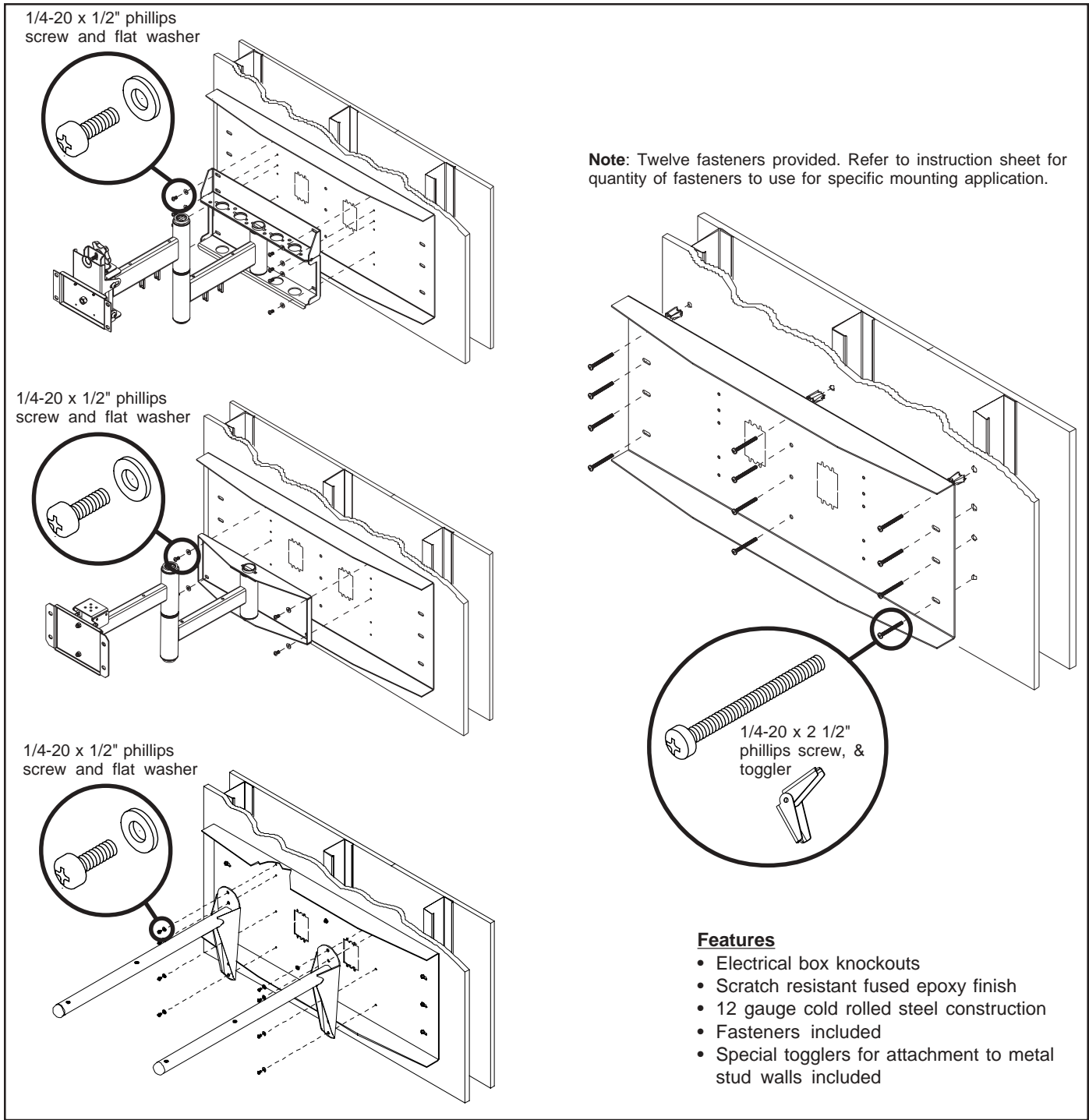

MODELS: WSP 450, WSP 450S, WSP 450W, WSP 460, WSP 460S, WSP 460W, WSP 470, WSP 470S, WSP 470W



Features

- Electrical box knockouts
- Scratch resistant fused epoxy finish
- 12 gauge cold rolled steel construction
- Fasteners included
- Special togglers for attachment to metal stud walls included

Architects Specifications:

The Triple Stud Wall Plate shall be a Peerless model _____ and shall be located where indicated on the plans. It shall be constructed of 12 gauge cold rolled steel. It shall include special togglers for attachment to a metal stud wall and 1/4-20 x 1/2" screws and washers for attachment of a Peerless **WMJ 025H** series TV Wall Mount to the Triple Stud Wall Plate. The finish shall be scratch resistant Black, White, or Silver Fused Epoxy. Assembly and installation shall be done according to instructions provided by the manufacturer.

TECHNICAL DATA SHEET

MODELS: WSP 450, WSP 450S, WSP 450W, WSP 460, WSP 460S, WSP 460W, WSP 470, WSP 470S, WSP 470W

NOTES:

ALL DIMENSIONS: $\frac{\text{INCH}}{\text{MM}}$
UNLESS OTHERWISE SPECIFIED

CL = CENTER LINE

MATERIAL: 12 GAUGE COLD ROLLED STEEL

Models **WSP 450, WSP 450S, and WSP 450W** attach to studs on 16" (406 mm) centers.

Models **WSP 460, WSP 460S, and WSP 460W** attach to studs on 20" (508 mm) centers.

Models **WSP 470, WSP 470S, and WSP 470W** attach to studs on 24" (610 mm) centers.

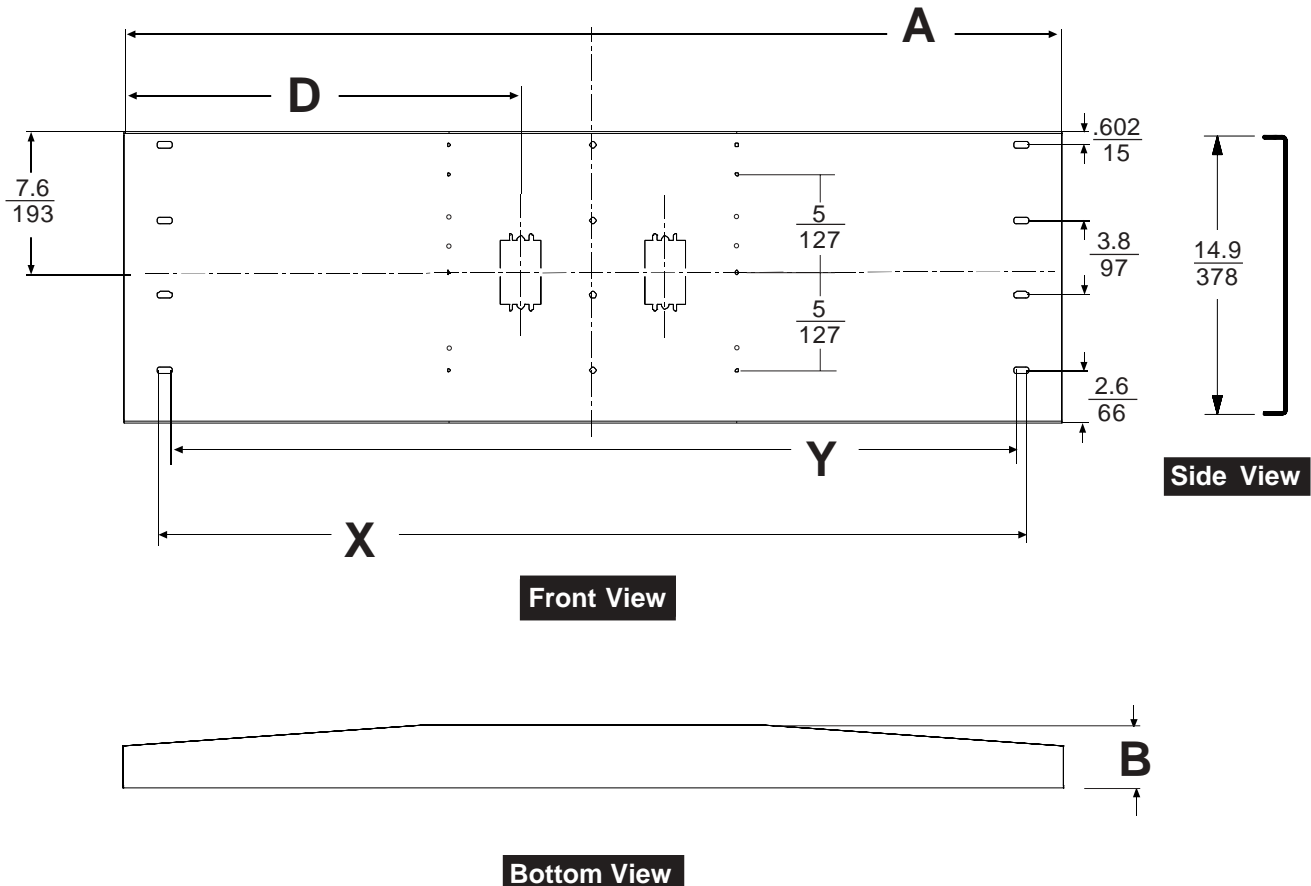

	WSP 450, WSP 450S, WSP 450W	WSP 460, WSP 460S, WSP 460W	WSP 470, WSP 470S, WSP 470W
ELECTRICAL KNOCKOUTS	YES	YES	YES
D	14 in. (356 mm)	18 in. (457 mm)	20.625 in. (524 mm)
A	36 in. (914 mm)	44 in. (1118 mm)	49.25 in. (1251 mm)
X	32.5 in. (826 mm)	40.5 in. (1029 mm)	48.5 in. (1232 mm)
Y	31.5 in. (800 mm)	39.5 in. (1003 mm)	47.5 in. (1207 mm)
B	3 in. (76 mm)	3 in. (76 mm)	2.625 in. (66.7 mm)
MAX. LOAD CAPACITY	175 lb (79 kg)	175 lb (79 kg)	175 lb (79 kg)
WEIGHT	22 lb (10 kg)	27 lb (12 kg)	32.5 lb (14.7 kg)
SHIPPING WEIGHT	24.5 lb (11.1 kg)	30 lb (13.6 kg)	33.5 lb (15.2 kg)